

CODE/ADDENDA 2010/2011A APPROVED  
 RELEASED FOR PRODUCTION  
 Q.C. \_\_\_\_\_ DATE \_\_\_\_\_

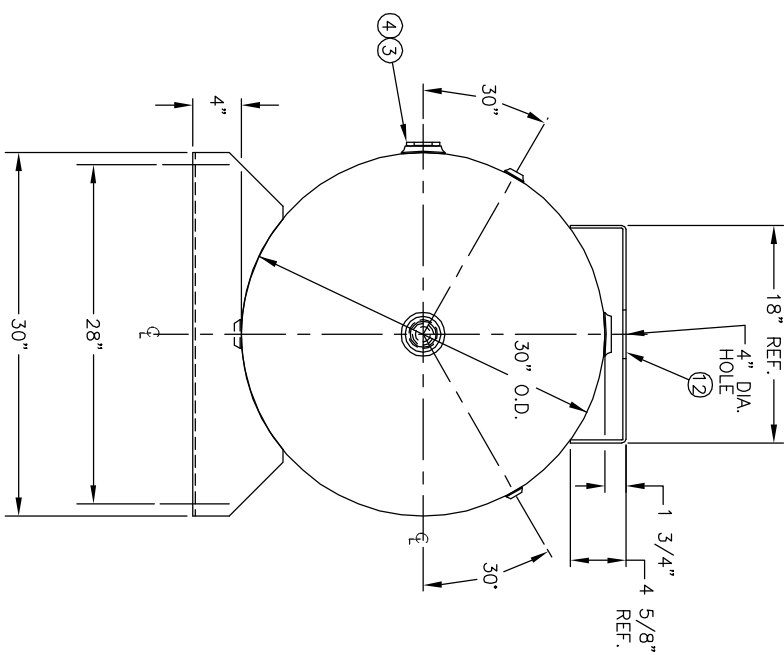
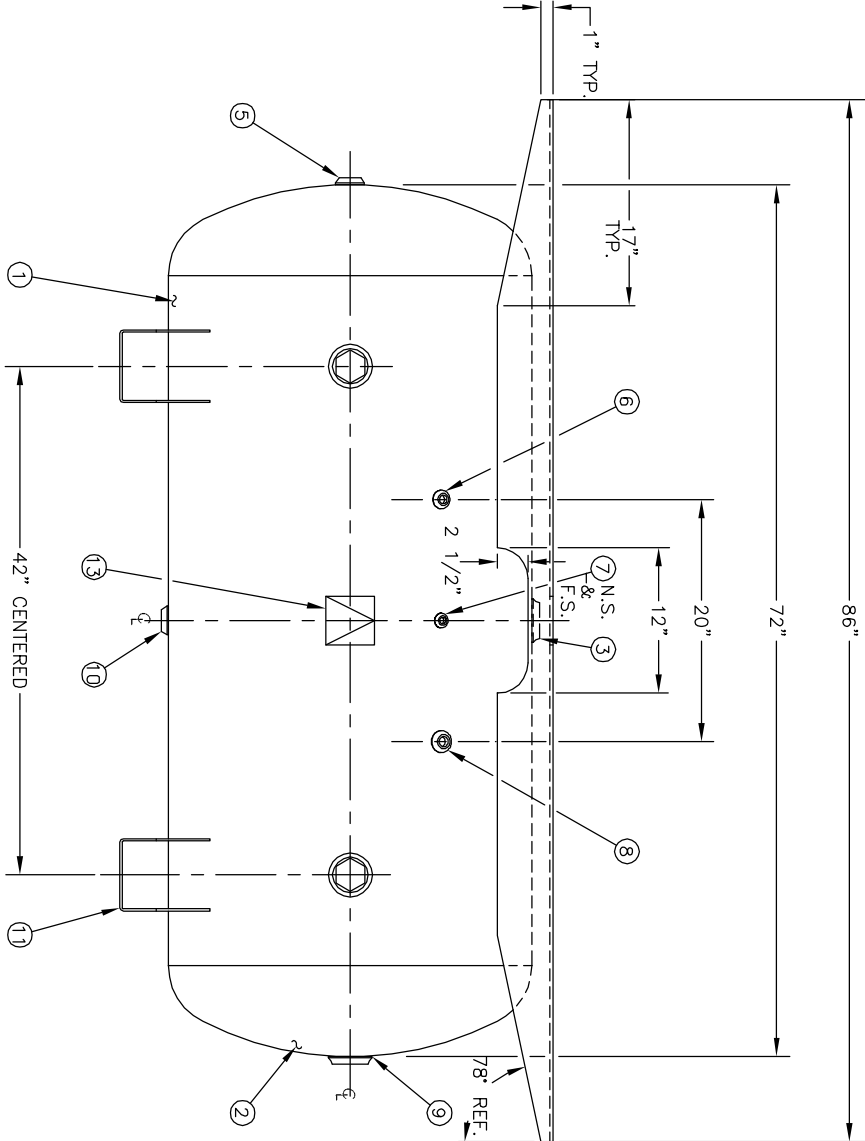

NO.	QTY	DESCRIPTION	SPEC	SUB-DWG.
3	3	2"-NPT 1500# RADIAL FLANGE	SA-181-70	
4	2	2"-NPS PLUG		
5	1	1"-NPT 1500# FLAT FLANGE	SA-181-70	
6	1	3/8"-NPT 1500# FLAT FLANGE	SA-181-70	
7	2	1/4"-NPT 1500# FLAT FLANGE	SA-181-70	
8	1	1/2"-NPT 1500# FLAT FLANGE	SA-181-70	
9	1	2"-NPT 1500# FLAT FLANGE	SA-181-70	
10	1	1"-NPT 1500# RADIAL FLANGE	SA-181-70	
11	2	STANDARD SADDLE FOR 30" DIA.		A84452
12	1	1/4" X 26 1/4" X 86" PLATFORM	C1008	
13	1	ASME DATA PLATE	C1010	

SPECIFICATIONS

O.D. 30 LGH. 72 SH. HD.  
 MAMP 200 PSI @ 650 F  
 RT- MDMT -20 F @ 200 PSI CAL. 200 SA. 50.9  
 EXMT TEST Wt. 700# CUFT. 26.7  
 CRN F0628.1C HD  
 WELD DETAILS: M-1932  
 STD. TOLERANCES (UNLESS OTHERWISE NOTED): M-2461



200 GALLON  
 STD. HORIZ. W/EXTENDED PLATFORM  
 Q:\3000

DRAWN BY: JR  
 BY: AWA  
 DATE: \_\_\_\_\_  
 SCALE: NONE  
 DRAWING NO.: 302701

SM	DATE	BY	REVISION
4		JR	
5		BAK	

APP	NOTES
AWA	